

DRAWING LEGEND:

- PROPOSED 225mm ϕ STORM DRAINAGE
- EXISTING STORM DRAINAGE
- EXISTING STORM DRAINAGE TO BE DECOMMISSIONED
- PROPOSED HIGH LEVEL PERCOLATION DRAINAGE
- PROPOSED LAND DRAIN / UNDERDRAIN
- PROPOSED STORM GULLY
- DENOTES PROPOSED SOAK PIT
- DENOTES PROPOSED WATER BUTT
- DENOTES DIFFUSER BOX
- DENOTES RAIN PLANTER

62.2

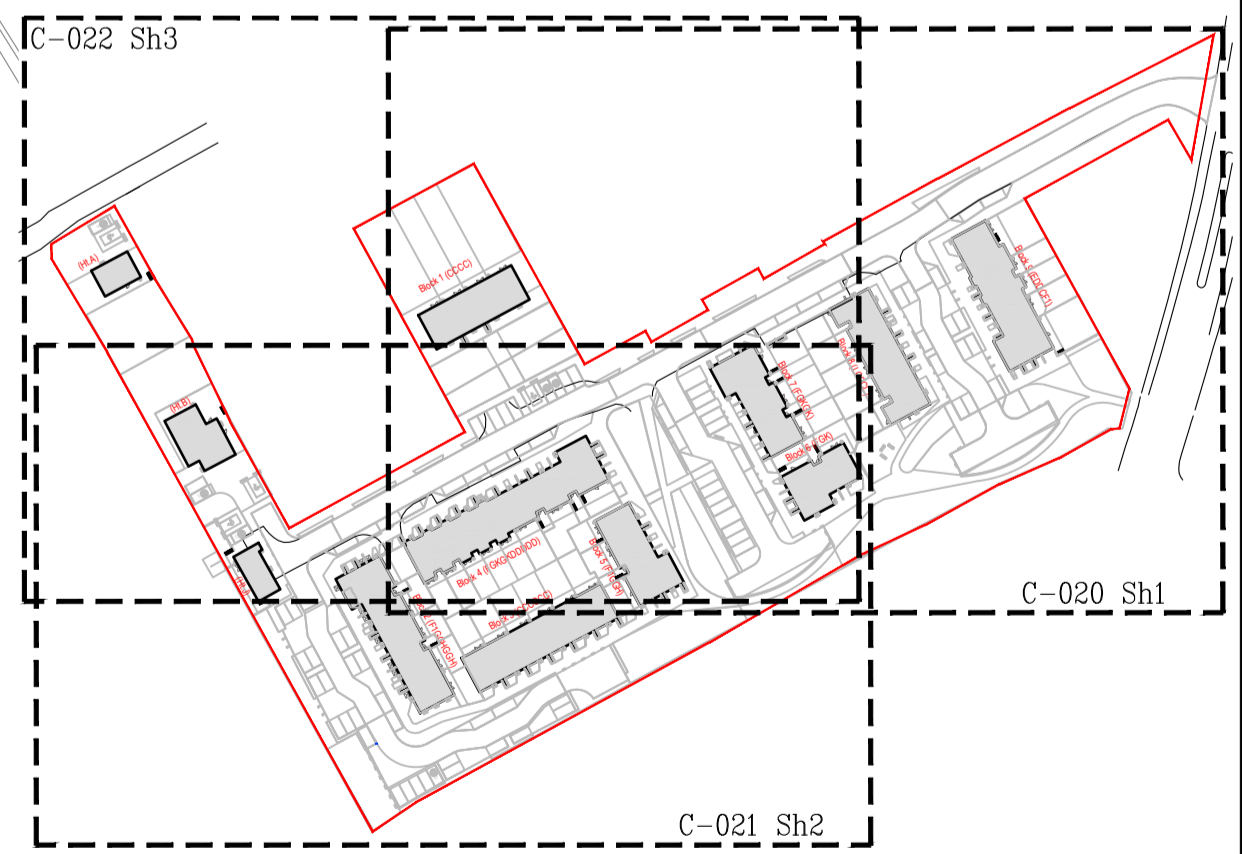

0375 STORM DRAIN DIVERSION TO ACCOMMODATE NEW PROPOSED HOUSING UNITS

NEW STORM MANHOLE CONSTRUCTED ON EXISTING 0375 STORM DRAIN CL:61.00 IL:58.22 (LEVELS TO BE CONFIRMED) PROPOSED CONNECTION LEVEL 58.37

BIO SWALE: TIE IN FROM DIFFUSER BOXES UNDER THE PERMEABLE PARKING AREAS AND THE HIGH LEVEL PERCOLATION PIPEWORK

PERCOLATION OVERFLOW: HIGH LEVEL, 0150 PERCOLATION PIPEWORK @ 5M CENTRES WITH PRE-DRILLED HOLES (5,6 & 7 O'CLOCK ORIENTATION), SURROUNDED IN 503 DRAINAGE STONE AND WRAPPED IN TERRAM. EACH TRENCH TO HAVE REDUCED COVER PROTECTION SLAB AS PER IW DETAILS STD-WW-08

BIO DETENTION AREA
TOP OF BANK LEVEL 61.500
BASE LEVEL 59.780
TYP WATER LEVEL 59.880
45M³ TOTAL STORAGE VOLUME
PLANTING TO LANDSCAPE ARCH / PARKS DEPARTMENT DETAILS

NEW STORM MANHOLE S2.1 CONSTRUCTED ON EXISTING 0375 STORM DRAIN CL:61.00 IL:58.400 (LEVELS TO BE CONFIRMED) PROPOSED CONNECTION LEVEL 58.080

TYP. MANHOLE TO LAND DRAIN / UNDERDRAIN 1.425M CL TO IL

TYP. MANHOLE TO LAND DRAIN / UNDERDRAIN 1.425M CL TO IL

45M³ TOTAL STORAGE VOLUME
PLANTING TO LANDSCAPE ARCH / PARKS DEPARTMENT DETAILS

BIO DETENTION AREA
TOP OF BANK LEVEL 61.000
BASE LEVEL 59.280
TYP WATER LEVEL 59.380
45M³ TOTAL STORAGE VOLUME
PLANTING TO LANDSCAPE ARCH / PARKS DEPARTMENT DETAILS

© HAYES HIGGINS PARTNERSHIP

Rev. No.	Date	Description	Rev. No.	Date	Description
PL1	08.04.22	PART 8	TD	MC	NP
PL2	03.11.22	ARCH COMMENTS INCORPORATED	TH	MC	NP

Rev. No.	Date	Description	Rev. No.	Date	Description
PL1	08.04.22	PART 8	TD	MC	NP
PL2	03.11.22	ARCH COMMENTS INCORPORATED	TH	MC	NP

NOTES:

- THIS DRAWING TO BE READ IN CONJUNCTION WITH ALL RELEVANT ARCHITECTS, SERVICE ENGINEERS DRAWINGS & SPECIFICATIONS.
- ALL LEVELS ARE STRUCTURAL UNLESS NOTED OTHERWISE.
- ALL WORKS TO BE CARRIED OUT IN ACCORDANCE WITH THE RELEVANT BUILDING REGULATIONS.
- DO NOT SCALE - WORK TO FIGURE DIMENSIONS ONLY.



Drawing Title:
NATURAL BASE SOLUTIONS SH2 OF SH3

Date: 02.12.21
Scale: A1 - 1:250, A3 - 1:500

Drawn By: E.HOARE
Checked By: M.CARR
Approved By: N.PATTERSON

Client: KILDARE CO. CO.

Job Description: HOUSING DEVELOPMENT AT GREENSFIELDS, MAYNOOTH, Co. KILDARE

Project No: 21KK001
Drawing Ref: C-021
Rev: PL2

Part 8

Hayes Higgins Partnership
Gas House Lane, Kilkenny.

No. 1000, De. Street Lane, Kilkenny, Co. Wick. Tel: 051 881231. Fax: 051 881232. Email: info@hayeshiggins.com

COPY: 21KK001-020 Natural Base Solutions.dwg